

Plat of Survey

of

Lot 1 of Certified Survey Map No. 4658,

recorded in Vol. 30 of Certified Survey Maps of Walworth County on Page 314 and located in the Southwest 1/4 of Section 14, Town 3 North, Range 15 East, Town of Richmond, Walworth County, Wisconsin.

Surveyed for: **Ryan DeBuck**

W8053 Turtle Lake Road
Delavan, Wisconsin. 53115

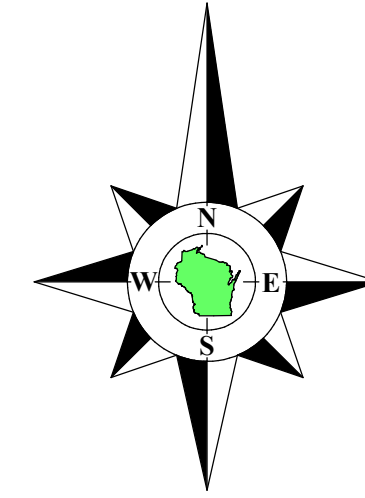

Bearings referenced to the North line of the Southwest 1/4 of Section 14-3-15, recorded as N87°11'15"E in the Wisconsin State Plane Coordinate System, South Zone, (NAD-27).

Coordinates are referenced to the Wisconsin State Plane Coordinate System, South Zone, (NAD-27).

Tax Parcel
CR 1400002

Turtle Lake Road

Presumed 66' Wide

Center 1/4 Corner
Section 14-3-15
N. 264,848.18
E. 2,351,993.34

N87°11'15"E 926.80'

North line of the Southwest 1/4 of Section 14-3-15.
N87°11'15"E 2639.78'
recorded as(N87°11'15"E 2639.83')State Plane

N87°12'39"E 926.80'

Lot 1
Tax Parcel
CA465800001

5.000 Acres
217,786 Sq.Ft.
4.540 Acres
197,741 Sq.Ft.
Exclusive of R.O.W.

Tax Parcel
CR 1400005

S87°11'15"W 926.80'

Tax Parcel
CR 1400005

Copyright 2016 by Olson Land Surveying, LLC.

All rights reserved. No part of this survey plat may be reproduced or transmitted in any form by any means - graphic, electronic, or mechanical, including photocopying, tracing, or information storage and retrieval systems - without permission in writing from Douglas G. Olson, Olson Land Surveying, LLC.

I, Douglas G. Olson, Wisconsin Professional Land Surveyor, do hereby certify that this survey was performed by me, or under my direction in full compliance with the owner's/agent's instructions and Chapter A-E 7 of the Wisconsin Administrative Code "Minimum Standards for Property Surveys"; and that this map is an accurate representation thereof to the best of my knowledge and belief.

Douglas G. Olson
Wisconsin Professional Land Surveyor - 2093

Survey Date: March 22, 2016.

Revisions: No. 1 – Recorded CSM
 No. 2 – Proposed House Addition

Scale in Feet
1" = 50'

45 South Wisconsin Street | P.O. Box 322
Elkhorn, Wisconsin. 53121
Telephone: (262) 723-3434
Facsimile: (262) 723-8044
Email: doug@olsonsurveying.com
Website: www.olsonsurveying.com

OLSON
LAND SURVEYING, LLC
Rural | Residential | Commercial

L-5 and L-6 Symbols & Abbreviations		N	North
	Found Corner Section Corner	E	East
	Found Iron Rod	W	West
	Set Iron Pipe, 1" dia.		
	Obtained Information		
	Utility Pedestal		
	Utility Pedestal		
	Concrete Cover		
	Asphalt Surface		
	Gravel Surface		
	Concrete Surface		
	Patio Blocks		
	Feet		
	Inches		

Sheet 1 of 1 Sheets

Job Reference Number

2022.019

Notes:

- 1) This survey plat is not certified unless signed and sealed in red ink.
- 2) This survey is subject to Wisconsin lien laws. This Plat of Survey is the notice of intent to file lien. Lien waiver required.

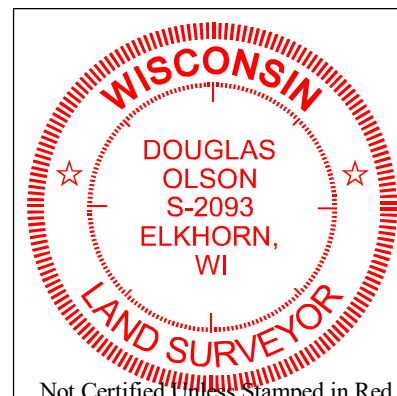

Not Certified Unless Stamped in Red.

West 1/4 Corner
Section 14-3-15
N. 264,718.65
E. 2,349,556.79 —

Found Rod leaning
1.15' S89°13'03"E —
of corner — RESET.

N2°12'04"W 235.00'

Tax Parcel
CR 1500010

Southwest Corner
Section 14-3-15
N. 262,073.34
E. 2,349,458.47

— $N2^{\circ}12'04''W$ 2647.36'
west line of the Southwest $1/4$ of Section 14-3-15.